

HATSAN Riptor

CO₂ BB Air Pistol

OPERATION MANUAL



RIPTOR



STEEL BB

.177 (4.5 mm)



12g

CO₂ Powered



350 FPS

Velocity



15 Rounds

BB Capacity

READ THIS OWNER'S MANUAL COMPLETELY. This airgun is not a toy. An airgun should be treated with the same respect as a firearm. Follow the safety instructions found in this owner's manual, and keep this manual in a safe place for future use.

⚠ WARNING: NOT A TOY. ADULT SUPERVISION REQUIRED. MISUSE OR CARELESS USE MAY CAUSE SERIOUS INJURY OR DEATH. MAY BE DANGEROUS UP TO 330 YARDS (301 METERS)

THIS IS A HIGH POWERED AIRGUN FOR USE BY THOSE 16 YEARS OF AGE OR OLDER. READ ALL INSTRUCTIONS BEFORE USING. THE PURCHASER AND USER SHOULD CONFORM TO ALL LAWS GOVERNING THE PURCHASE, USE, AND OWNERSHIP OF AIRGUNS.



SAFETY INSTRUCTIONS



WARNING: THIS AIRGUN CAN CAUSE SERIOUS INJURY OR DEATH. READ AND FOLLOW THE INSTRUCTIONS CAREFULLY. DO NOT LOAD A PROJECTILE INTO THE AIRGUN UNTIL YOU ARE READY TO SHOOT. IF YOU DO LOAD A PROJECTILE AND THEN DECIDE NOT TO SHOOT, REMOVE IT EITHER MANUALLY OR BY SHOOTING THE AIRGUN AT A SAFE TARGET. AN UNLOADED AIRGUN WHICH IS "ON SAFE" IS SAFEST. ACCIDENTS HAPPEN FAST, PLEASE HANDLE THE AIRGUN SAFELY.

Airguns differ in their operation and you are never ready to fire any gun until you are thoroughly familiar with it. Read the following operating instructions thoroughly prior to use. These symbols, , mark warnings and cautions in this operation manual. Carefully follow them for your own safety and the safety of others.



WARNING: THIS AIRGUN CAN CAUSE SERIOUS INJURY OR DEATH. READ AND FOLLOW THE INSTRUCTIONS CAREFULLY. DO NOT LOAD A PROJECTILE INTO THE AIRGUN UNTIL YOU ARE READY TO SHOOT. IF YOU DO LOAD A PROJECTILE AND THEN DECIDE NOT TO SHOOT, REMOVE IT EITHER MANUALLY OR BY SHOOTING THE AIRGUN AT A SAFE TARGET. AN UNLOADED AIRGUN WHICH IS "ON SAFE" IS SAFEST. ACCIDENTS HAPPEN FAST, PLEASE HANDLE THE AIRGUN SAFELY.



WARNING:

EYE PROTECTION
REQUIRED
Shooting Glasses
Must be worn

Operating Procedures

1. Parts of Your Air Pistol
2. Operating the Safety
3. Installing and Removing CO₂ Cartridge
4. Loading and Unloading Projectiles
5. Aiming and Firing Safely
6. Use and Handling of CO₂ Cartridge
7. Maintenance, Cleaning, and Storage
8. Reviewing Safety
9. Repair / Service / Warranty

DESCRIPTION

1. Parts of Your Air Pistol



Illustration 1

Illustration 1-B

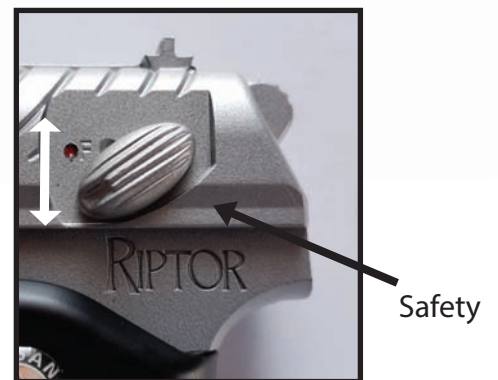
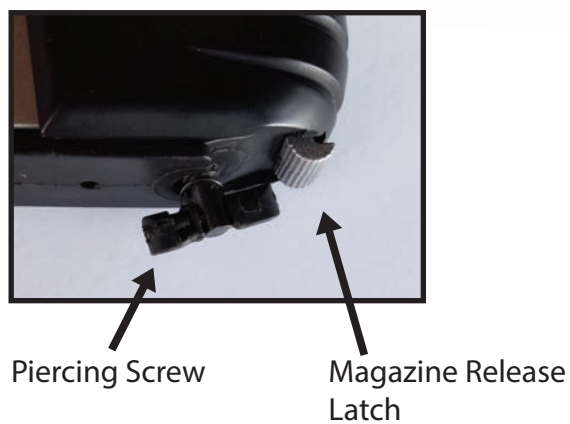

Illustration 1-A



OPERATION

⚠ WARNING: BE SURE THE AIRGUN IS ALWAYS POINTED IN A SAFE DIRECTION. NEVER POINT THE AIRGUN AT SOMEONE, EVEN IF IT IS UNLOADED. ALWAYS ASSUME AND HANDLE THE AIRGUN AS IF IT WERE LOADED AND READY TO FIRE.

⚠ CAUTION

- ALWAYS MAKE SURE THAT THE MUZZLE POINTS INTO A SAFE DIRECTION.

2. Operating the Safety

2A. To Put the Riptor “ON SAFE”

- Locate the safety on the left side of the airgun behind the slide release
- Push upward until the letter “S” next to the white dot appears (Illustration 2A)



Illustration 2A

2B. To Take the Riptor “OFF SAFE”

- Locate the safety on the left side of the airgun behind the slide release
- Push downward until the letter “F” next to the red dot appears (Illustration 2B)



Illustration 2B

⚠ CAUTION

LIKE ALL MECHANICAL DEVICES, AN AIRGUN’S SAFETY CAN FAIL. EVEN WHEN THE SAFETY IS “ON SAFE”, YOU SHOULD CONTINUE TO HANDLE THE AIRGUN SAFELY. NEVER POINT THE AIRGUN AT ANYTHING YOU DO NOT INTEND TO SHOOT.

⚠ CAUTION

NEVER LOAD THE MAGAZINE UNTIL YOU HAVE VERIFIED THE AIRGUN WILL DISCHARGE CO₂ PROPERLY.

OPERATION

2C. Slide Lock Release

- Locate the slide lock release on the left side of the airgun, above and behind the trigger
- Push downward to release the slide from its rearward locked position (Illustration 2C)

NOTE: The slide automatically locks rearward after the last BB has been fired from the magazine.



Illustration 2C

3. Removing and Installing CO₂ Cartridge

3-1. Installing a New CO₂ Cartridge

- Point the airgun in a SAFE DIRECTION
- Put the airgun “ON SAFE” (See step 2A)
- Release the detachable all-in-one magazine by depressing the magazine release latch (Illustration 3A)
- Check to ensure the magazine is empty
- Make sure a projectile is not loaded (See step 4)
- If it contains CO₂, see step 3-2
- Remove the empty CO₂ cartridge (See step 3-2)
- Insert a 12g CO₂ cartridge, with the small neck of the cartridge pointing upward.
 - Use the integrated thumb screw to turn the piercing screw clockwise until the CO₂ cartridge is pierced. A slight seepage of gas may occur until the screw is tight (Illustration 3B).
- Insert the all-in-one magazine into the grip until it locks in place by the magazine release latch (Illustration 3C)
- Make sure the cartridge has been punctured. With the airgun unloaded, pointed in a SAFE DIRECTION, take “OFF SAFE” (See step 2B), release slide and pull the trigger to fire. If it does not fire, tighten the piercing screw some more and repeat this step.



Illustration 3A



Illustration 3B



Illustration 3C

IMPORTANT: Never force a CO₂ cartridge into or out of place. Do not store your airgun with a cartridge in it. When not in use, empty the CO₂ cartridge and remove it from the airgun. This will prolong the life of your airgun seals (See step 3-2).

⚠ WARNING: USE ONLY 12g CO₂ CARTRIDGE. ANY ATTEMPT TO USE OTHER TYPES OF GAS CARTRIDGES COULD BE EXTREMELY DANGEROUS AND COULD RESULT IN SERIOUS INJURY OR DEATH. GASES OTHER THAN CO₂ COULD RESULT IN AN EXPLOSION OR RUPTURE OF THE AIRGUN

OPERATION

⚠ WARNING: KEEP HANDS AND FACE AWAY FROM ESCAPING CO₂ GAS. IT MAY CAUSE FROSTBITE IF ALLOWED TO COME IN CONTACT WITH SKIN. ALWAYS MAKE SURE THE CO₂ CARTRIDGE IS EMPTY BEFORE ATTEMPTING TO REMOVE IT FROM THE AIRGUN BY SLOWLY TURNING THE GAS CARTRIDGE PEIRCING SCREW COUNTER-CLOCKWISE ALL THE WAY UNTIL YOU NO LONGER HEAR THE ESCAPE OF CO₂ GAS.

3-2. Removing a CO₂ Cartridge

- Point the airgun in a SAFE DIRECTION.
- Put the airgun “ON SAFE” (See step 2A).
- Check to ensure the detachable all-in-one magazine is empty.
- Make sure the airgun is unloaded (See step 4).
- Point the airgun in a SAFE DIRECTION.
- Put the airgun “OFF SAFE” (See step 2B).
- Fire the airgun until it will not fire, indicating the CO₂ cartridge is empty.
- Put the airgun “ON SAFE”.
- Release the magazine by pressing the magazine release latch toward the rear of the airgun.
- Slowly loosen the piercing screw, releasing the remaining gas until the empty CO₂ cartridge falls out.
- Remove the empty CO₂ cartridge and discard (handle with care, as the cartridge may be very cold).

4. Loading and Unloading BB's

4-1. Loading BB's

- Always point the airgun in a SAFE DIRECTION
- Put the airgun “ON SAFE” (See step 2A)
- Press the magazine release button and release the all-in-one magazine
- Using your thumb, press the BB follower down and slide it to the left to hold it in place
- Load up to 15 (.177 caliber) steel BB's through the loading port (Illustration 4)
- Gently release the follower
- Insert the magazine into the grip until the latch catches (Illustration 1A)



Illustration 4



USE ONLY .177 CALIBER (4.5mm) STEEL BB'S. DO NOT REUSE BB'S THAT HAVE BEEN FIRED OR ARE DEFORMED. DO NOT USE DARTS, BALL BEARINGS, BUCK SHOT, OR OTHER FOREIGN OBJECTS BECAUSE THEY CAN CAUSE INJURY TO YOU OR SOMEONE ELSE AND CAN DAMAGE OR JAM THE AIR PISTOL.

OPERATION

⚠ WARNING: NEVER ASSUME THAT BECAUSE THE AIRGUN NO LONGER FIRES A PROJECTILE AND/OR THE MAGAZINE IS REMOVED FROM THE GRIP FRAME THAT A PROJECTILE IS NOT LODGED IN THE BARREL. ALWAYS TREAT THE AIRGUN AS THOUGH IT IS LOADED AND WITH THE SAME RESPECT YOU WOULD A FIREARM.



SHOOTS STEEL BB'S ONLY!

4B. Unloading BB's

- Point the airgun in a SAFE DIRECTION
- Put the airgun "ON SAFE" (see Step 2A)
- Release the magazine by pressing the magazine release latch(Illustration 1A)
- Check to ensure the detachable "All-In-One" magazine is empty
- Point the airgun in a SAFE DIRECTION
- Insert the "All-In-One" Magazine into the grip until the latch catches
- Put the airgun "OFF SAFE" (see Step 2B)
- Pull the trigger to fire until the airgun no longer shoots projectiles
- Put the airgun "ON SAFE"

NOTE: The airgun must be charged with CO₂ when following these steps. But remember, do not store your airgun with a CO₂ cartridge in it (See step 3-2)

IMPORTANT: Firing the airgun with too little gas pressure left may cause a BB to get stuck in the barrel.

NOTE: Many factors affect airgun performance and velocity, including brand and type of projectile, lubrication, barrel condition, and temperature.

OPERATION

5. Aiming and Firing Safety

CAUTION

You and others with you should always wear shooting glasses for required eye protection

- Always aim your airgun in a **SAFE DIRECTION**. When you are sure of your target and backstop and the area around the target is clear, take “OFF SAFE” (See step 2B) and pull the slide rearward to cock the hammer.
- Squeeze the trigger to fire
- Do not shoot at hard surfaces or the surface of water. Projectiles may bounce off or ricochet and hit someone or something you had not intended to hit.
- Do not shoot at fragile surfaces such as glass or mirrors.
- Always choose your target carefully. Only targets which cannot be completely penetrated or which will not ricochet should be used.
- The backstop should be checked for wear before and after each use. Replace the backstop if the surface is worn, damaged, or if a ricochet occurs.
- The airgun is correctly aimed when the front sight blade is positioned between the rear notches and even with the rear sight. The top of the front sight blade should be even with the top of the rear sight notches. The bullseye should appear to rest on top of the front sight (See Illustration 5).

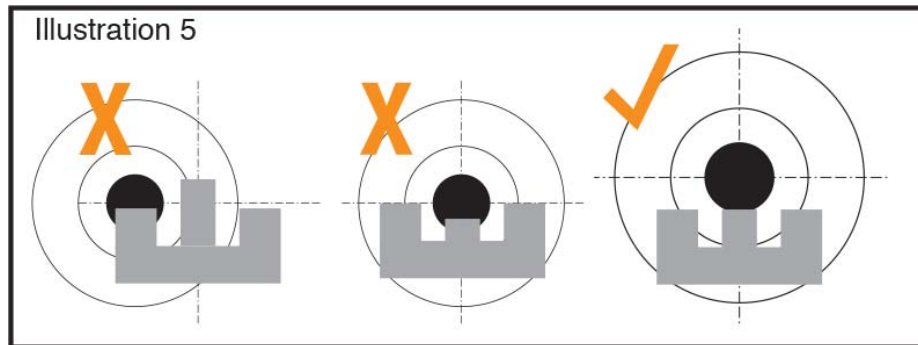

CAUTION

YOUR BACKSTOP SHOULD BE INSPECTED FOR WEAR BEFORE AND AFTER EACH USE. DISCONTINUE USE IF THE BACKSTOP SURFACE SHOWS SIGNS OF FAILURE. ALWAYS PLACE THE BACKSTOP IN A LOCATION THAT WILL BE SAFE IN THE EVENT THE BACKSTOP FAILS. DISCONTINUE USE OF BACKSTOP IF THE PROJECTILE REBOUNDS OR RICOCHETS.

OPERATION

6. Use and Handling of CO₂ Cartridges

Possible certain conditions may affect a CO₂ cartridge, which can impact its proper performance. These conditions include usage, maintenance, and storage at temperatures higher or lower than normal outdoors temperatures (60 - 80 °F/ 16 - 27 °C). Another condition may be when the gun is fired rapidly.

1. High temperatures can increase pressure in the CO₂ cartridge and also within the gun, leading to higher than standard operating pressure. This excess pressure could cause the gun to malfunction or be permanently damaged. Maximum storage or operating temperature should never exceed 122 °F (50 °C). This temperature can be reached if you leave the gun under direct sunlight on a bright day or left in a closed automobile. Thus, to ensure proper gun operation, do not expose it to high temperatures or direct sunlight for long periods of time. Otherwise, the CO₂ cartridge could overheat and explode, which could damage the airgun and cause injuries or death to people around it.
2. Fast consecutive shooting may produce a decrease of temperature in the gun, as well as the CO₂ cartridge, resulting in lower projectile velocities and may lower gas pressure enough so that the pistol will not fire. This condition can be especially apparent when shooting in cold weather and can be avoided by allowing more time between shots.
3. During rapid fire, the muzzle velocity of each shot will diminish. This can affect shooting accuracy. You will get fewer shots from a CO₂ cartridge during rapid fire.
4. Care should be demonstrated to ensure that the gun is not shot with a CO₂ cartridge that is low in pressure. Indicators of insufficient pressure are:
 - A. The sound of the shot is not as loud as when the cartridge is full.
 - B. The projectile hits the target, but in a lower position than it would with a full CO₂ cartridge, resulting from a low shooting speed.



CAUTION

NEVER REUSE A CO₂ CARTRIDGE FOR ANY PURPOSE



CAUTION

ALWAYS CHECK TO MAKE SURE THE AIRGUN IS UNLOADED WHEN GETTING FROM STORAGE, FROM ANOTHER PERSON, OR FROM ANY OTHER CIRCUMSTANCE.

OPERATION

⚠ WARNING: CO₂ CARTRIDGES MAY EXPLODE AT TEMPERATURES ABOVE 122 DEGREES F. DO NOT TAMPER, MANIPULATE, OR INCINERATE THE CO₂ CARTRIDGES. DO NOT EXPOSE TO HEAT OR STORE CO₂ CARTRIDGES AT TEMPERATURES ABOVE 122 DEGREES F.

7. Maintaining Your Airgun

With care and routine inspections, your airgun will provide many productive shooting sessions. Abuse, neglect, and/or continued exposure to the elements will impair the performance of any airgun. To ensure continued proper function, apply 1 to 2 drops of silicone oil onto all moving parts such as the BB follower, gas cartridge piercing screw, and the trigger hinge every ~1200 shots.



CAUTION

BEFORE ANY CARE, CLEANING, OR MAINTENANCE, ALWAYS BE SURE YOUR AIRGUN IS UNLOADED. ALWAYS KEEP YOUR AIRGUN POINTED IN A SAFE DIRECTION. IT IS IMPORTANT TO PERFORM ROUTINE INSPECTIONS AND MAINTAIN YOUR AIRGUN PROPERLY.



CAUTION

OILS THAT CONTAIN ACID OR RESIN CAN DAMAGE SEALS AND POSSIBLY THE FINISH OF THE AIRGUN.

⚠ WARNING: AN AIRGUN THAT IS NOT OPERATING PROPERLY MAY BE DANGEROUS. IT SHOULD BE KEPT SAFELY FROM USE BY ANYONE UNTIL REPAIRED OR DESTROYED. DO NOT TRY TO TAKE YOUR AIRGUN APART. IT IS DIFFICULT TO REASSEMBLE AND IMPROPER DISASSEMBLY OR REASSEMBLY CAN CAUSE SERIOUS INJURY OR DEATH.



SAFETY INSTRUCTIONS

9. Reviewing Safety

- Always aim in a SAFE DIRECTION. Always keep the muzzle of the airgun pointed in a SAFE DIRECTION.
- Always keep your finger off of the trigger and out of the trigger guard until ready to shoot.
- Never point the airgun at anything you do not intend to shoot.
- Always treat the airgun as though it is loaded and with the same respect you would a firearm.
- Never look down the barrel of the airgun.
- Always keep the airgun “ON SAFE” until you are ready to shoot.
- Always check to see if the airgun is “ON SAFE” and unloaded when getting it from another person or from storage.
- Use only the proper size and type of projectiles as it is marked on the airgun.
- Never reuse ammunition.
- Do not shoot at hard surfaces or at the surface of water. The BB may bounce off or ricochet and hit someone or something you do not intend to hit.
- Do not shoot at fragile objects such as windows or mirrors.
- Place the backstop in a location that will be safe if the backdrop should fail.
- Your backstop should be checked for wear before and after each use.
- All backstops are subject to wear and will eventually fail. Replace your backstop if the surface is worn or damaged or if a ricochet occurs.
- Do not attempt to disassemble or tamper with your airgun. Unauthorized repairs or modifying the function of your airgun in any way could be unsafe and will void your warranty.
- Before you store your airgun make sure it is unloaded the CO₂ cartridge is removed and is “ON SAFE”.
- Always store your airgun in a secure location away from unauthorized users and away from ammunition.

10. Repair / Service / Warranty

Do not return defective or damaged airgun to dealer. If your airgun needs repair, call HatsanUSA Inc. (877) 2784448 or visit www.HatsanUSA.com and fill out and submit a “Customer Service Form”. DO NOT ATTEMPT TO DISASSEMBLE YOUR AIRGUN! Your airgun requires special tools and fixtures to repair it. Any disassembly or modification not performed by HatsanUSA Inc. will void the warranty.



WARNING: DO NOT BRANDISH OR DISPLAY THIS AIRGUN IN PUBLIC. IT MAY CONFUSE PEOPLE AND MAY BE A CRIME. POLICE AND OTHERS MAY THINK IT IS A FIREARM. DO NOT CHANGE THE COLORATION AND MARKINGS TO MAKE IT LOOK MORE LIKE A FIREARM. THAT IS DANGEROUS AND MAY BE A CRIME.

CARE



CAUTION

YOUR AIRGUN WAS ENGINEERED AND MANUFACTURED TO DELIVER OPTIMUM PERFORMANCE AND SAFETY. ANY MODIFICATION OR TAMPERING WITH THIS AIRGUN MAY CAUSE A MALFUNCTION, VOID YOUR WARRANTY AND MAY MAKE IT UNSAFE TO USE. ANY CHANGE IN PERFORMANCE (SUCH AS A LOWERED TRIGGER PULL FORCE AND SHORTENED TRIGGER TRAVEL) INDICATES POSSIBLE MODIFICATION TAMPERING AND/OR WEAR. SUCH AIRGUN SHOULD BE INSPECTED, REPLACED, OR PROPERLY REPAIRED BY ONLY QUALIFIED HATSANUSA SERVICE PERSONNEL. AN AIRGUN THAT HAS BEEN DROPPED SHOULD BE CHECKED BY QUALIFIED PERSONNEL TO ENSURE THAT ITS FUNCTION HAS NOT BEEN AFFECTED.

180-Day Limited Warranty

This product is warranted to the original retail consumer for a period of 180 days from the date of purchase against defects in material and/or workmanship and is not transferable.

WHAT IS COVERED

Replacement parts and labor.

WHAT IS NOT COVERED

Shipping charges to HatsanUSA, Inc. for defective product and damages caused by abuse or failure to perform normal maintenance as well as any other expense.

Consequential damages, or incidental expenses, including damage to property.

Some states do not allow exclusions or limitations, or the exclusion may not apply to you.

WARRANTY CLAIMS

Warranty claims and repair for U.S. customers only. Call HatsanUSA at 877-278-4448 or go to www.HatsanUSA.com and submit a "Customer Service Form". If a return is necessary, you will be issued a return authorization number. Write this number **boldly** on the box and return the product prepaid to HatsanUSA, Inc. Your name, address, phone number, and information explaining the defect must be included in the package. A copy of the original purchase receipt must also accompany the return.

IMPLIED WARRANTIES

Any implied warranties, including the implied warranties of merchantability and fitness for a particular purpose, are limited in duration to 180 days from date of retail purchase. SOME STATES DO NOT ALLOW LIMITATIONS ON HOW LONG AN IMPLIED WARRANTY LASTS, SO THE ABOVE LIMITATIONS MAY NOT APPLY TO YOU. TO THE EXTENT ANY PROVISION OF THIS WARRANTY IS PROHIBITED BY FEDERAL, STATE, OR MUNICIPAL LAW WHICH CANNOT BE PREEMPTED, IT SHALL NOT BE APPLICABLE. THIS WARRANTY GIVES YOU SPECIFIC LEGAL RIGHTS, AND YOU MAY ALSO HAVE OTHER RIGHTS WHICH VARY FROM STATE TO STATE AND COUNTRY TO COUNTRY.



HATSAN



[Facebook.com/HatsanUSA](https://www.facebook.com/HatsanUSA)



[Twitter.com/hatsanusa](https://twitter.com/hatsanusa)



[YouTube.com/c/HatsanUSAInc](https://www.youtube.com/c/HatsanUSAInc)

www.hatsanusa.com
www.hatsan.com.tr